

# CWS PROPOSED DEDICATION TO CITY OF AUSTIN

- APPROXIMATELY 2 ACRES OF LAND
- CONSTRUCTION APPROXIMATELY 1,700 L.F. OF HIKE & BIKE TRAIL TO PARKS DEPARTMENT SPECIFICATIONS
- LANDSCAPING OF 2 ACRE DEDICATED AREA
- 2,000 - 3,000 S.F. OF TOWN LAKE PUBLIC SPACE WITH RESTROOMS
- BOAT DOCK BROUGHT UP TO CODE

Selzer  
Associates

4514 Travis Street  
Suite 235  
Dallas, Texas 75205

214 528-4499  
214 528-7375 Fax

ISSUED  
7/18/07

## TYPICAL LANDSCAPE DETAILS

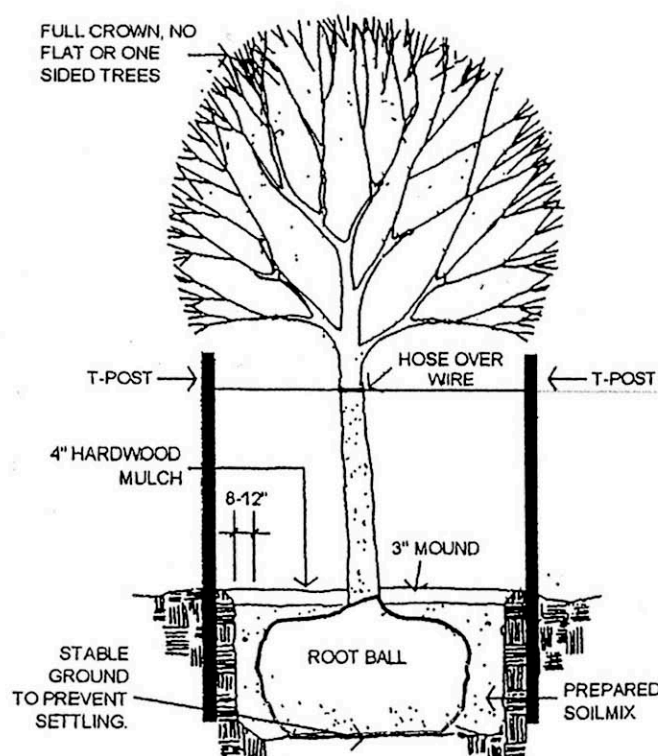

TREE PLANTING DETAIL

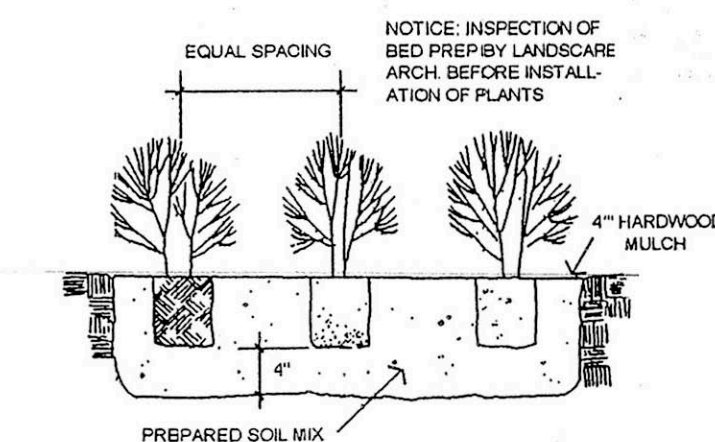

SHRUB PLANTING DETAIL

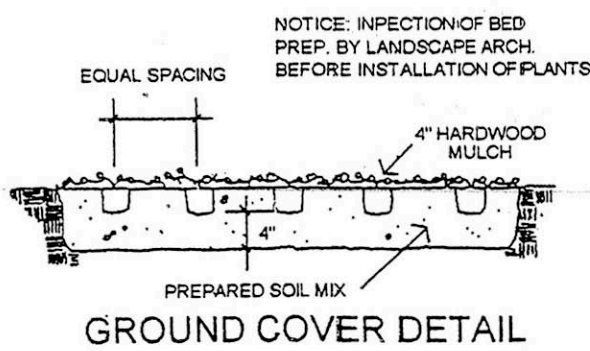

GROUND COVER DETAIL

## HIKE & BIKE TRAIL DETAILS

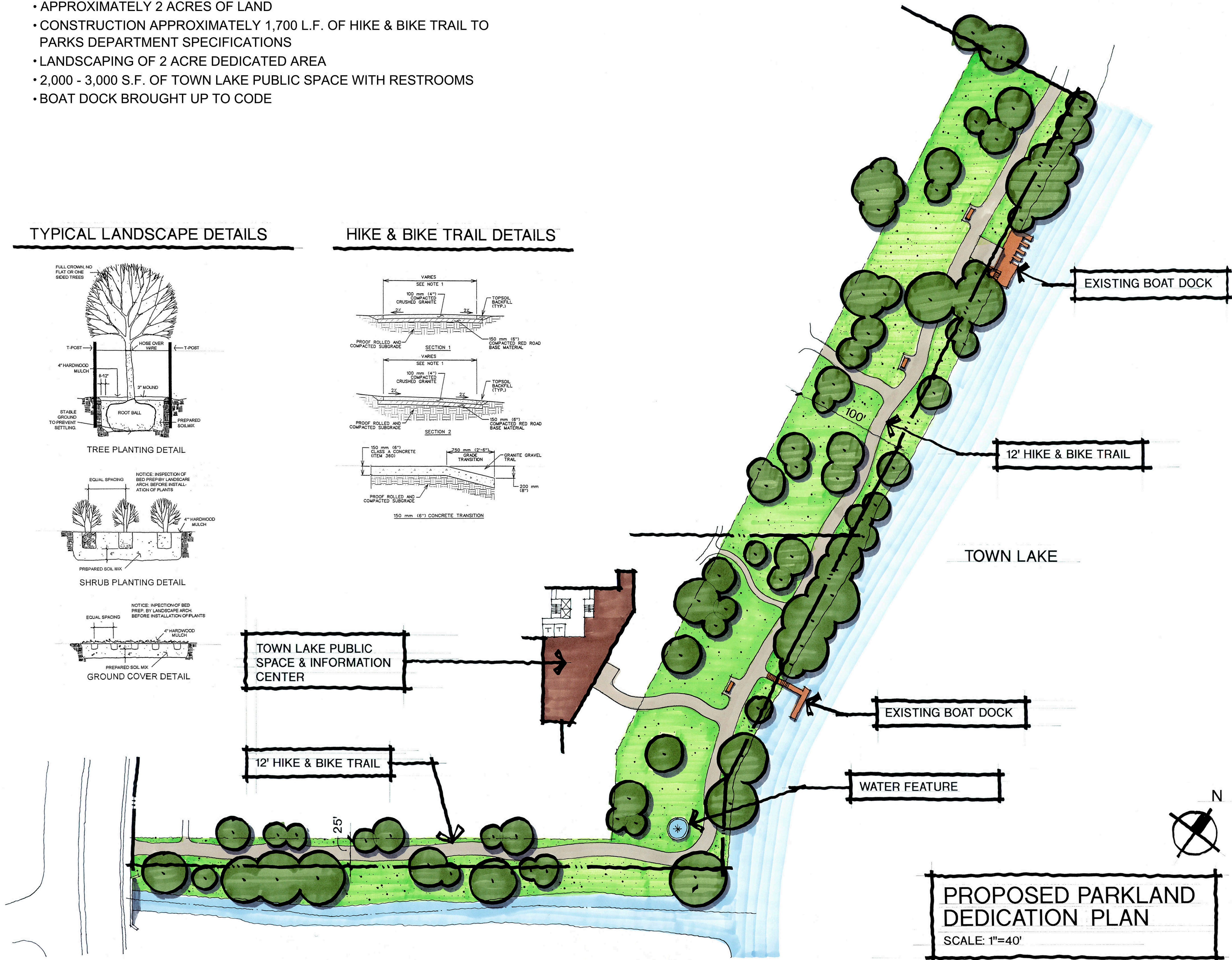
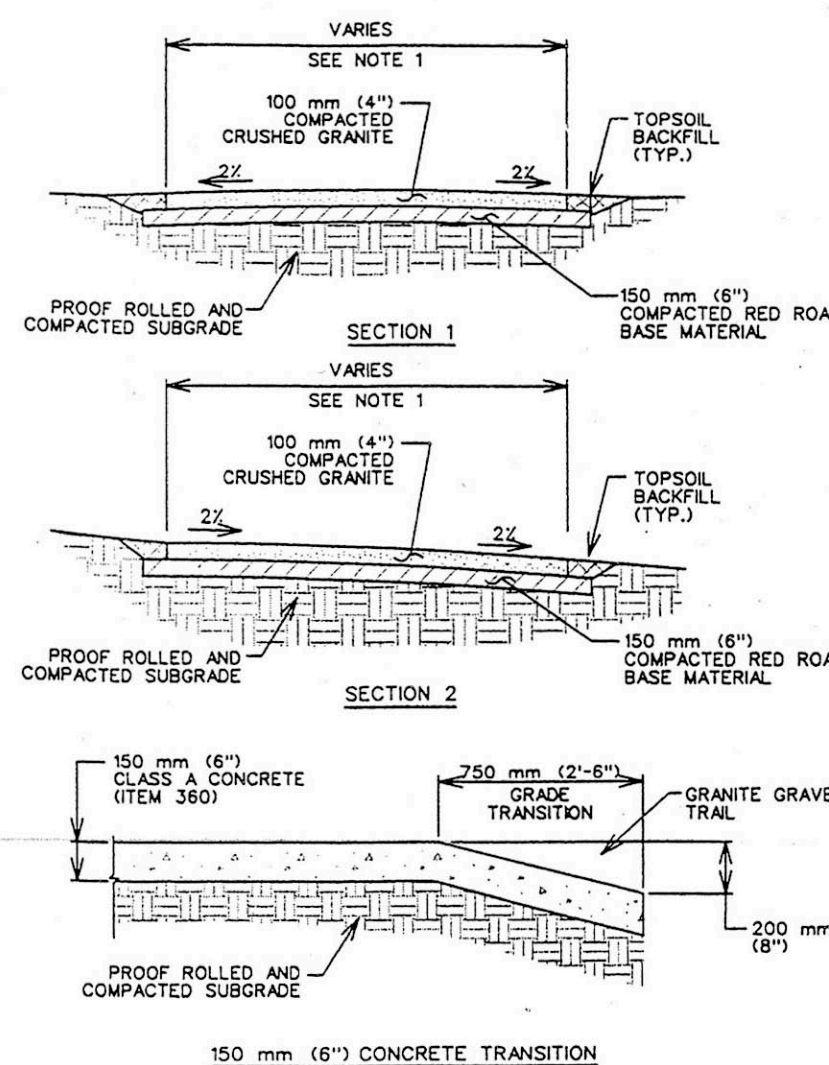

PROPOSED PARKLAND  
DEDICATION PLAN

SCALE: 1"=40'

RIVERSIDE RESIDENCES  
222 & 300 E. RIVERSIDE  
AUSTIN, TEXAS

SHEET